

料号 material No.	品名 Parts Name	型号 Part NO.	尺寸Dimension (mm)						导线截面	最大电流	材料 厚度												
40-LSNBS 2-5	锁扣叉形裸端子	LSNBS 2-5	<table border="1"> <tr> <th>B</th> <th>F</th> <th>L</th> <th>E</th> <th>D<math>\varnothing</math></th> <th>d<math>\varnothing</math></th> </tr> <tr> <td>8.1</td> <td>6.5</td> <td>16</td> <td>4.8</td> <td>4.1</td> <td>2.3</td> </tr> </table>						B	F	L	E	D $\varnothing$	d $\varnothing$	8.1	6.5	16	4.8	4.1	2.3	16-14A, W. G 1.5-2.5mm <sup>2</sup>	27A	0.8
B	F	L	E	D $\varnothing$	d $\varnothing$																		
8.1	6.5	16	4.8	4.1	2.3																		
			螺拴尺寸						5.3														

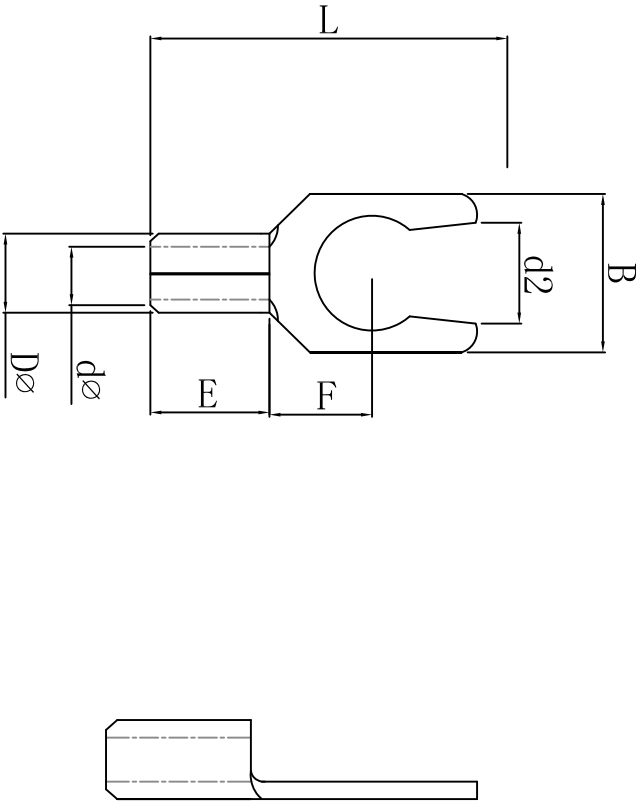

材 质: 紫铜(镀镍)  
材料厚度: 0.8mm



未经许可不得修改和复印  
该知识产权属于技术质量部

DIMENSION	TOLERANCES							DWG. BY	UNIT	mm
0.0 0.00	±0.5							<i>liu liang</i>	REV.	A
FIRST ANGLE PROJ		A	NEW PART	<i>callian</i>	<i>zy. wang</i>	<i>202105</i>	APP. BY	DWG. NO.	HIMA/QR-JZ-40-LSNBS 2-5	
	LTR.	REVISION RECORD	DWG. BY	CHK. BY	DATE	CHK. BY	DATE	APP. BY	DWG. NO.	
								<i>wang zhiqian</i>		

**HIMA** 惠华 苏州惠华电子科技有限公司